

FIG 256B PIPE INTERRUPTER

FEATURES & BENEFITS

NABIC Fig 256B pipe interrupter is classified as a DB type device suitable for protecting up to fluid category 4. This device has a moving element which seals the ventilation gaps during normal flow conditions. When negative pressures occur on the inlet side which could cause siphonage, the membrane retracts seals the flow ports and simultaneously vents the outlet side of the pipe interrupter. WRAS approved.

- Size Range: DN10 - DN20
- O Rings EPDM
- Female inlet connection available on DN15 and 20
- In compliance with: BS EN1717 & BS EN 806-5



PRESSURE RATINGS & TEMPERATURE RANGE

MAX WORKING PRESSURE (BAR)	MIN - MAX TEMPERATURE (°C)
0.5 to 10.0	-20 to 60

DIMENSIONS & WEIGHTS

SIZE DN	BSP G	L	D	Kv
10M	3/8"	89	29	0.26
15M	1/2"	89	29	0.26
20M	3/4"	90	29	0.61
15F	1/2"	82	29	0.26
20F	3/4"	68	29	0.61

PART NAME & MATERIALS

ITEM NO.	PART NAME	MATERIAL
1	Body Material	Brass
2	Internals	Plastic
3	Membrane	EPDM

DIMENSIONAL DRAWING

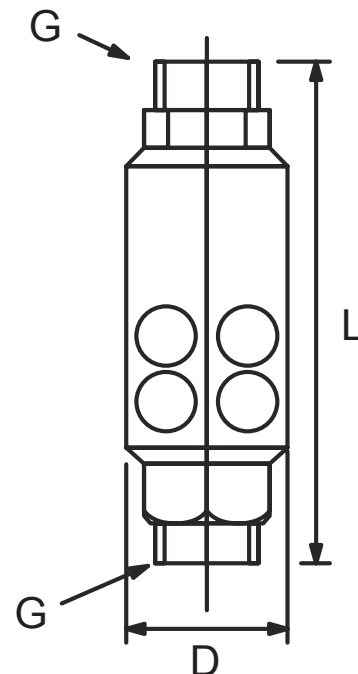

MEDIUM

Water.

PIPE CONNECTIONS

Male BSP inlet and outlet connections: G3/8", G1/2" and G3/4" to ISO228A. DN15 and DN20 female connections G1/2" and G3/4" to ISO228.

PRODUCT TESTING

All valves are 100% production tested.

APPROVALS



ISO 14001 Reg No. EMS 78657



FM00311 ISO 9001



FLOW CHARACTERISTICS

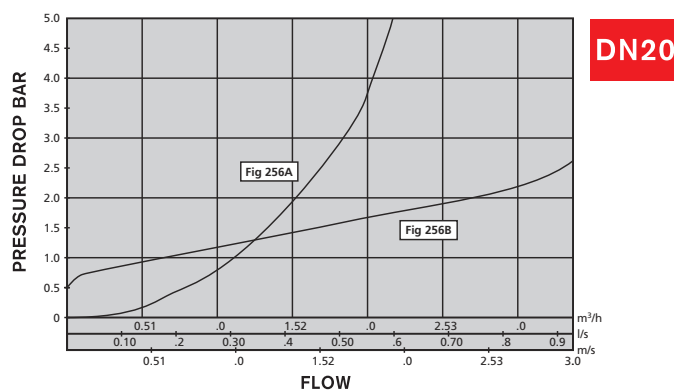
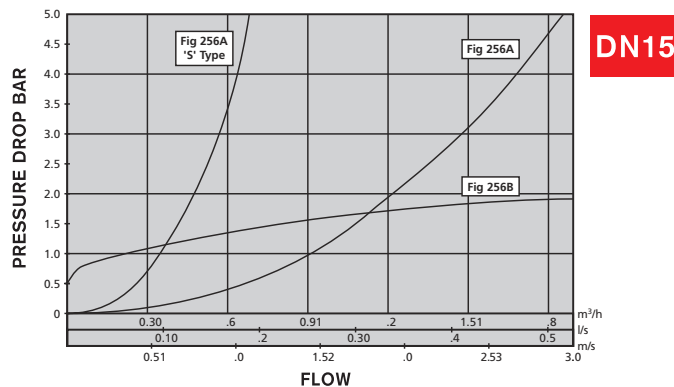
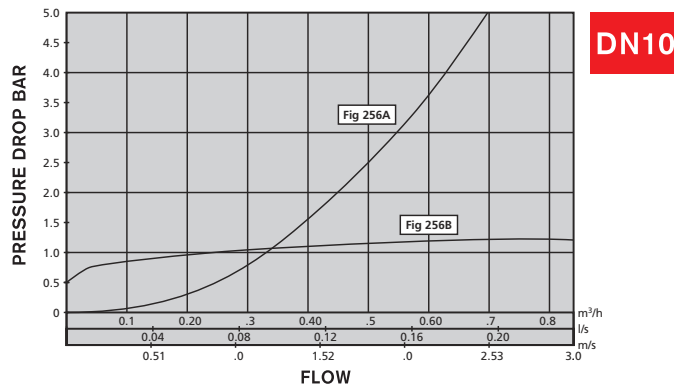

INSTALLATION

The devices should be fitted in the vertical position with downwards flow in a readily accessible location. They must be installed with the lowest point of the air apertures, at least 300mm above the highest possible water level. The only exception is on urinals where the DC type can be fixed not less than 150mm above the sparge pipe outlet. There shall be no valve or restriction on the outlet side of the interrupter and they should not be fitted in locations liable to flooding.

NABIC®

46-48 WILBURY WAY, HITCHIN, HERTFORDSHIRE, SG4 0UD
 Tel: +44 (0) 1462 443 278 Fax: +44 (0) 1462 443 127
 E-mail: nabicsales@cranebsu.com Web: www.nabicvalves.com

Every effort has been made to ensure that the information contained in this publication is accurate at the time of publishing. NABIC assumes no responsibility or liability for typographical errors or omissions or for any misinterpretation of the information within the publication and reserves the right to change without notice.

N_EFig_256B
0216

OUR GENIUS IS VALVES

